

NOTES

The copyright of this drawing is held by Lea Hough & Co Chartered Surveyors LLP.

Do not scale from this drawing. All dimensions are approximate and must be checked and verified by the contractor prior to works commencing on site.

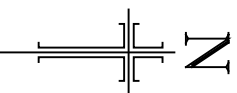

REVISIONS

REV	DESCRIPTION	DATE	AMENDED
-	-	-	-

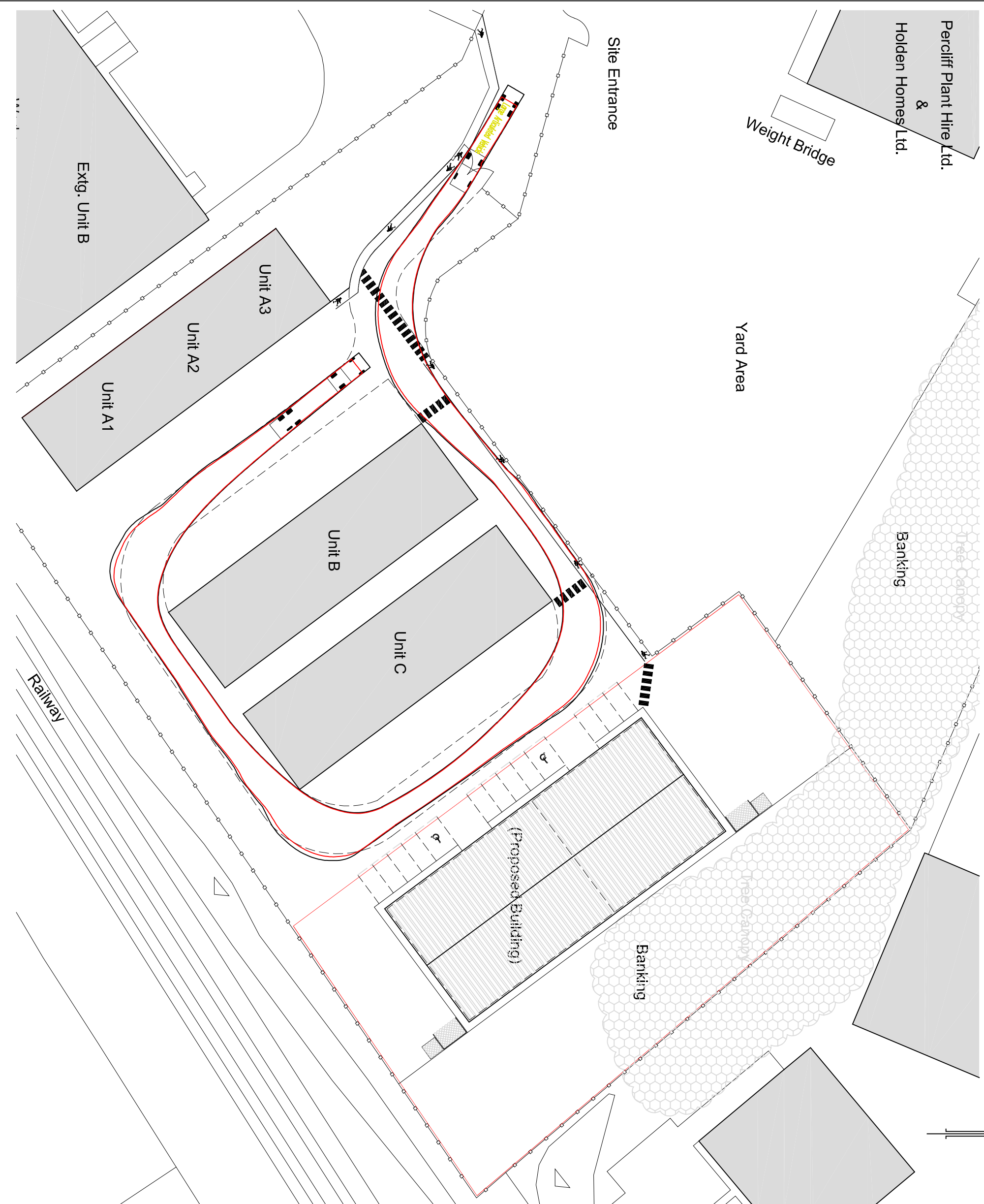

LeaHough

CHARTERED SURVEYORS

Survey Valuation Design Planning Sales

Blakewater House
Phoenix Business Park
Blakewater Road
Blackburn
Lancashire
BB1 5RW
Tel: 01254 260196
Email: info@leahough.co.uk
Web: www.leahough.co.uk



CLIENT:
B. Ingleby & M. Holden,
c/o Lea Hough Chartered Surveyors

PROJECT ADDRESS:
Proposed Unit D,
Percliffe Way,
Phillips Road,
Blackburn,
BB1 5PF.

PROJECT TITLE:
Proposed Industrial Building

DRAWING TITLE:
Proposed Swept Path & Pedestrian Access Plan

PAPER SIZE:	DRAWING NUMBER:	REV
A3	BS.16-029/06	-
SCALE:	DATE:	DRAWN BY:
1:500	March 2018	GN